

INITIAL PARKS AND TRAILS ASSESSMENT

CITY OF SULTAN

In partnership with the
University of Washington

CITY OF SULTAN PROJECT LEAD
Andy Galuska

UNIVERSITY INSTRUCTORS
Rachel Berney
Jess Zimbabwe

COURSE: CEP 460



TABLE OF CONTENTS

Acknowledgments and Credits	ii.
Introduction	01
Methods and Findings	03
Geographic Information Systems	03
Trails Assessment and Inventory	07
Parks Assessment and Inventory	13
Community Engagement	24
Recommendations	30
References	32
Appendices	33
Appendix 1: Demographic Profile	33
Appendix 2: Trails Assessments	34
Appendix 3: Parks Assessments	35
Appendix 4: Notable Survey Responses	47



ACKNOWLEDGMENTS

City of Sultan: Andy Galuska, Nate Morgan, Will Ibershof, Victoria Forte and Mayor John Seehuus

Ms. Flynn's class at Sultan Elementary School

CREDITS

FOR THIS REPORT

City of Sultan Project Lead: Andy Galuska

City Department: Planning

Instructors: Rachel Berney and Jess Zimbabwe

University Department: Community, Environment, and Planning

Course: CEP 460

Student Researchers:

Ryan Barbee

Jenna Brewington

Yohaly Camacho

Matthew Ellis

Kona Farry

Becca Fogel

Blair Ivy

Anabella King

Kate Merifield

Abdirisak Mohamed

Izumi Nance

Steffan Ortega

Maia Pagan

Kaelyn Thede

Abby Tish

Reb Zhou

FOR THE UNIVERSITY OF WASHINGTON LCY PROGRAM

LCY Faculty Co-Directors

Branden Born

Jennifer Otten

Program Manager: Teri Thomson Randall

Graphic Designer: Kirsten Wong

Communications: Daimon Eklund



INTRODUCTION

Teaming up with the Livable City Year program and the City of Sultan, sixteen students from the Community, Environment, and Planning (CEP) program at the University of Washington set out to answer two important questions to improve Sultan's parks and trails:

What does the city of Sultan have?

What do residents want for the future?

We set out doing research on the city and visited once before the partnership began to gain further insight. We organized ourselves into four groups according to our interests and skill sets, and began to brainstorm appropriate methodologies.

- One team would examine the existing trails and parks to create maps that show natural resources available in Sultan. Specifically, the maps would include topographical and floodplain data as key characteristics to plan for possible future parks and trails by revealing at-risk areas for flooding.
- Two other teams would assess Sultan's parks and trails using customized assessment tools to measure characteristics such as quality, safety, and walkability.
- A fourth team would attend community events such as Trunk or Treat to garner opinions of trails and parks from Sultan residents. This team created and distributed a survey to residents via several Sultan-related social media platforms and other physical events to analyze initial opinions. This community engagement team had a larger number of members so that many people could communicate with the other teams and with Sultan stakeholders.

All teams participated in background research on demographics and in construction of methodology.

As research commenced, we heard two key priorities from City staff. First, they need to gain a better understanding of what parks, trails, and open spaces exist today in city limits, as well as information on who maintains them and what condition they're in. Particularly, there was an interest in learning more about the private trails that exist in newer developments and how they contribute to mobility in those areas. This was the primary focus of our research, and the following pages will outline the results of our initial observations that future teams can build on as LCY's partnership with the City continues.

The City's second priority concerned inclusion of Sultan residents' voice and opinion in the trails and parks planning process. As we were told and soon discovered, Sultan is a small town with a vibrant community, and most everyone feels some level of attachment to the city and its happenings, so it is important to ensure their inclusion as a key stakeholder.

Our initial demographics work examined Sultan's history, changes over time, and its growth trajectory. Like many cities in the greater Puget Sound, Sultan has seen significant growth in recent years. With this growth has come new development, primarily off of Sultan Basin Road in the East side of town. Previously, much of this land was undeveloped, with most residential and commercial units concentrated in the downtown core. The growth in the Basin has been primarily residential, and as a result of this and the geography of the



area, many Sultan residents need to use Highway 2 for their connection to commerce as well as recreation opportunities. Private developers have, in some cases, created trail systems interlinking their neighborhoods, and some small play structures exist, but significant city parks or larger trails are not accessible to these residents.

As we're thinking about future recreation opportunities and community engagement, it's also important to understand who makes up this community today, and what trends indicate the future holds. We collected and analyzed data from the 2000 and 2010 censuses and the 2017 American Community Survey (ACS) to understand Sultan's demographic changes.

	2017	% CHANGE	2010	% CHANGE	2000
Residents	5,194	11.67%	4,651	39.5%	3,334
Families	1,229	7.62%	1,142	33.1%	858
Median household income	\$66,250	42.11%	\$46,619	-0.6%	\$46,921
Per capita income	\$30,343	26.60%	\$23,968	27.3%	\$18,822
Percent below poverty line	8.40%	-39.13%	13.80%	97.1%	7%
Unemployment rate	10.40%	31.65%	7.90%	64.6%	4.80%
White alone	76.00%	-11.83%	86.20%	-5.9%	91.60%
Percentage of population non-white	24%	73.91%	13.80%	64.3%	8.40%

Selected statistics from Appendix 1: Demographic Profile

Notably, Sultan's racial make-up is changing rapidly, falling from 92% white in 2000 to 76% white in 2017. This will have implications across areas such as community engagement and what citizens may desire in recreation opportunities.

We also noticed that median household income has risen significantly, percent in poverty is mostly back to pre-2008 recession levels, and the number of families has grown (mostly in line with population). Higher-income residents are likely to be interested in recreation opportunities that are inaccessible to others of lower income. While it is important for their social wellbeing and the City that such opportunities be available, we



must also take care to ensure that recreation is available to all residents, regardless of status. Additionally, families tend to be one of the most reliable users of parks, as they provide a safe opportunity to get kids outside and moving. As such, future teams may want to assess whether current parks meet families' needs.

METHODS

Our mission for Sultan made us answer two big questions. What parks and trails resources does Sultan have? What do Sultanites want in their parks and trails? In order to address these questions, our group divided into four main sub-teams:

- Geographic Information Systems
- Trails Assessment and Inventory
- Parks Assessment and Inventory
- Community Engagement

We chose to split up into teams in order to do a deep dive on each area. All these pieces came together to form a comprehensive assessment of Sultan's parks and trails. The GIS team catalogued parks and trails to see what Sultan has. Trails and Parks Assessment and Inventory teams assessed Sultan's parks and trails to see what Sultan has and to see what parks and trails may be lacking. The Community Engagement team interfaced with the residents of Sultan to gauge what they want from their parks and trails.

GEOGRAPHIC INFORMATION SYSTEMS

PDS MAP PORTAL

Once we determined that Geographic Information Systems (GIS) was the best tool to catalog the parks and trails of Sultan, we assigned a separate team with specialized knowledge and experience. This team visualized spatial data while factoring in whatever non-spatial data that may be relevant in the future.

Our process began with analysis of data in the Snohomish County Planning and Development Services (PDS) Map Portal. The PDS Map Portal is linked below, and contains a variety of GIS layer resources including parcel data, LIDAR imagery, topographic contours, etc., for all of Snohomish County. These layers can be downloaded as shapefiles using the video located on the portal webpage. No official data related to parks and trails existed in the portal, so this stage was entirely dedicated to determining which available data layers may have relevance to the project. Out of everything available, the only layers deemed important were the "Topographic Contour Lines" and the "Critical Area Site Plans" layers, because they had characteristics and thus informative input that could be translated to Sultan's open spaces and trails.

We had interest in the topographic information in its relation to trail users' experience. Our vision was for this data to help assess the "difficulty" (which, in this case, means "variability of topography" or something along those lines) of Sultan's trails. The idea for this came along because we had previously seen a similar assessment method used in Cougar Mountain, Washington. As it turns out, Sultan is considerably flat, save for a sharp increase in elevation that divides Sultan into two sides: a West side, which is lower in elevation and contains the downtown area as well as most of the city's parks, and an East side colloquially-known under



the misnomer (since it is actually higher in elevation) “The Basin.” The Basin contains most of Sultan’s new neighborhood development. Information and graphics contained later in the report will show that all of the trails are on mostly-flat land except for the evacuation trail, which is located near Sultan High School and was intentionally created to transport residents to higher elevation in the event of a major flooding event, as Sultan experiences frequent flooding.

Our interest in the layer entitled “Critical Area Site Plans” arose because of the city’s interest in building new parks in The Basin to accommodate population growth that comes with new development. Our previous project was a site containing wetlands, which require a legal buffer zone that prohibits construction.

According to the Snohomish County official website, Critical Areas can include wetlands, conservation areas, frequently flooded areas, geologically hazardous areas, and so on. As it turns out, we were right about these “critical areas” creating a similar legal buffer. In this case, the buffer appears to be 400-500 feet around each designated area. More details on this can be found in the corresponding link below.

TWO AUDIENCES FOR DATA RESOURCES

After our initial research, we determined which trail data our maps would communicate. Our goal as the GIS team was to make inventory, but after talking with city administrators, we decided on making two maps: one for city admin, and a second map for residents. The admin-targeted map would show the trails, parks, private trails, critical sites, and topography as a development overlay to show developable areas. At Sultan’s “Trunk or Treat” event, we learned that most residents were only really aware of Osprey Park, so in making the second map, we hope Sultan residents could use a publicly-available web app to broaden their knowledge of Sultan parks and trails. The lack of traffic from residents going to the trails had to do with lack of information available. Therefore, this web app could showcase the wonderful trails and parks of Sultan as a tool for the community, and also as an advertisement tool to increase foot traffic. Information of the web app could be distributed through resources like the Sultan Visitor Center.

DATA COLLECTION METHODOLOGY

Steps in Data Collection for Trails:

1. Downloaded Gaia App (GPS Hiking Map).
2. In teams of two walked the trails, while the App was active and recording.
3. Set waypoints for benches, view corridors, entrances and exits.
4. Took pictures during data collection for waypoint references.
5. Saved the collected data as shapefiles.

ARCGIS PRO DATA EDITING PROCESS

After sending a few teams of two to walk the trails of Sultan (over the course of three total visits to Sultan) with the Gaia GPS app on their phones, we had collected shapefiles for the Susie’s Trail network, the evacuation trail, and three private trails located in “the basin”. All of the trail data was compiled into an ArcGIS Pro project (and later a web app) along with the Topographic Contour Lines layer and the Critical Area Site Plan layer from

the Snohomish County PDS Map. Additionally, we managed to find floodplain data through a database on the Snohomish County website. The floodplain data was added per the request of city administrator Will Ibershof during our midterm presentation.

All of this data (both the data we gathered through Gaia GPS and the data that is already publicly available) is currently stored within our UW Google Drive folder, which will be shared with the graduate students who adopt this project after us.

Being able to visualize all of this data together in a single map was of great use, since everything was finally compiled together. Representatives from the City of Sultan seemed to agree during our final presentation.



Data for public web app

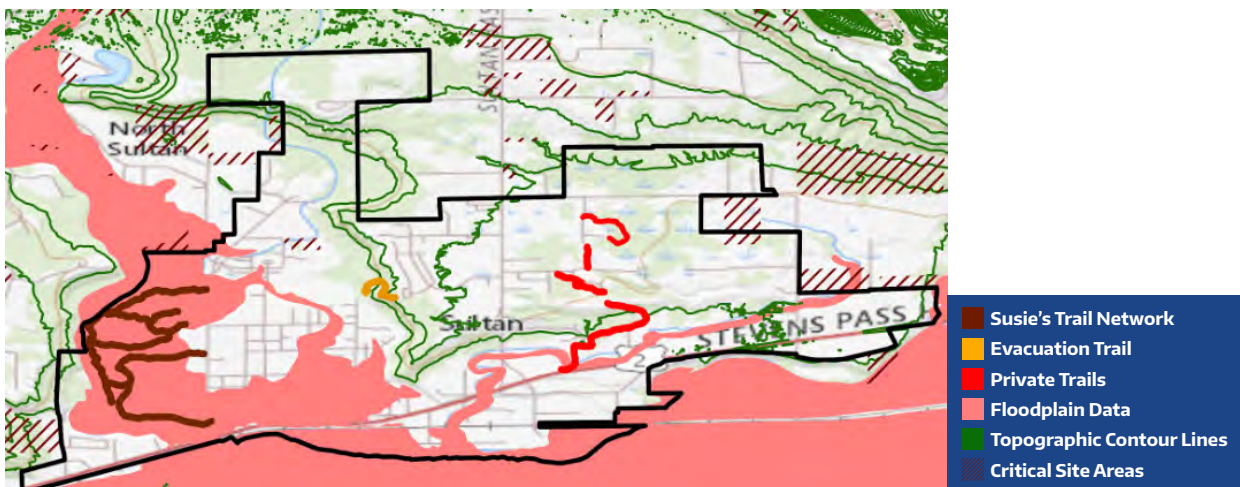

Data for city use



The images we presented are found below. These drafts are the result of coordinating ten weeks' worth of intensive data collection. The first map is the simpler map, created with the intention of showing it to Sultan residents to raise awareness of their available outdoor resources. The second map contains features relevant to city representatives looking to find good locations for construction of new parks.

The city representatives noted our lack of cataloged parks, which is mostly true. In the map labelled "Data for public web app," there are some green polygons on the West side of the map that resemble the parks. This is meant to be sample/placeholder data, since we couldn't find a way to accurately log park boundary data. Logging trails was easier since we could just use Gaia GPS and walk the trail, but no such tool existed for logging parks. Instead we traced over a basemap in GeoJSON and used what we had for the presentation. This data will be available in our LCY UW Google Drive. Because these shapes are merely the tracings of a pre-existing basemap, they are imprecise and definitely not exhaustive. Since the web app is for public use, if the shapes represent the parks and are generally recognizable as corresponding parks, that is what matters. We will leave the precise details of cataloging parks to the next LCY team, but recommend further and more accurate data collection.

The network of trails called "Susie's Trail" behind Osprey Park took multiple passes to record all the possible branching pathways. All of Susie's Trail was recorded in one afternoon, so the only caveat is that the trails, as they appear on the map, are actually five different shapefiles/layers on top of one another. Since our recordings occasionally overlapped, we spent a lot of time cutting out the extra lines to make one cohesive-looking trail. Additionally, you may notice that two of the trails have no elevation data (which is labelled "track points" in our data folders), which is because that data is completely fabricated. Gaia GPS was not used for those trails, since we didn't see them on our initial visit. We rearranged some points in ArcGIS Pro to complete the branching path network, and we thought it looked convincing. This is another point of imprecision we would like future teams to finalize.

CREATION AND NEED FOR WEB APP

Creating the web app was the final step, after the collection, cleaning, and mapping of the data. With the ESRI extension tool kit, we made interactive maps. After making our map available on the ArcGIS online Database, we linked it to the web app. The web app builder has templates and widgets that are available in helping you customize your app. The functions we wanted the web app to have was navigation, identification, and be able to report feature classes. The app is able to direct you to any trail and park by car and walking. The app allows you to identify trails and parks by hovering or clicking on the app. The app is also able to report feature classes. For example, if you're on a hike at Susie's Trail and you see a broken tree branch blocking the trail, the report widget allows you to report the incident, and sends the information to the web app administrators as a geo location with the notes. This is useful because it allows for city administrators monitoring the app

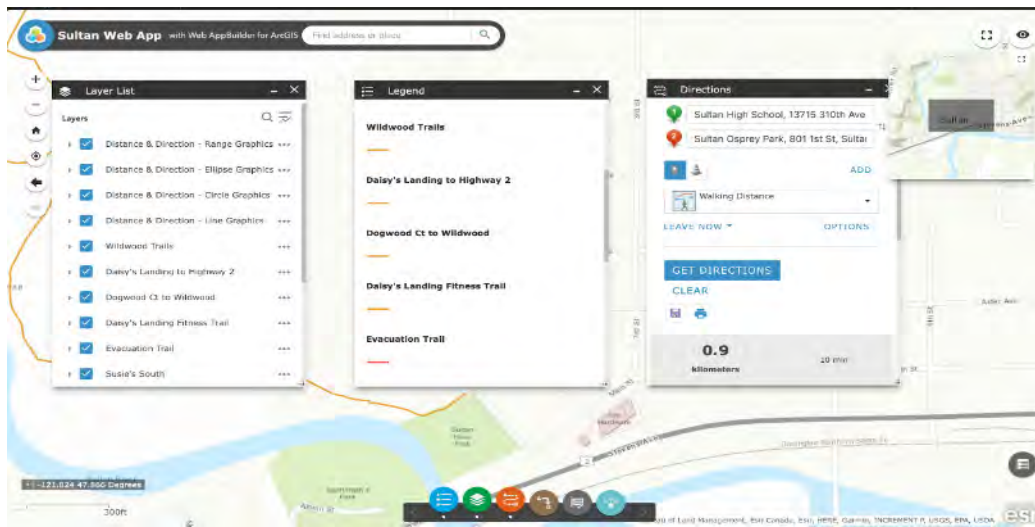

Link to Web App: <http://arcg.is/1POS1G>

to plan for maintenance in real-time. The report widget could also be used as survey for trail walkers and park participants to voice their concerns and opinions. The web app is an important asset for Sultan because it allows residents to use their phones to explore Sultan instead of carrying an extra map. The web app also contains the evacuation trail route, which can be used by schools to help direct students in the case of flooding.

TRAILS ASSESSMENT AND INVENTORY

METHODOLOGY

Before walking the trails ourselves, we carefully read the City of Sultan's Park, Recreation, and Open Space (PROS) Plan (City of Sultan, 2010), and related elements of the city's Comprehensive Plan to initially identify some of the trails we would be assessing. Neither of these plans included very comprehensive information on the trail systems in the city, so we then turned to Google Maps as well as maps of Sultan provided by the city (Appendix 2) to try to identify as many trails as possible. In our next step, we created an assessment tool to categorically identify the Sultan trails' strengths and areas of improvement. We reviewed the Gehl Quality Criteria (Gemzøe, 2006) and Dannenberg's Walkability Audit (Dannenberg, Cramer & Gibson, 2005) and used some elements from both to inform our own assessment tool. We visited Sultan three times over the quarter, first for a general tour, second to assess Susie's Trail and the Osprey Park trail network, and third to assess the private trails in the new developments off of Sultan Basin Road. To map each trail, we used the Gaia app to track our routes and tag notable features and photos along the way. We used our assessment tool on the public trails, specifically focusing on ADA accessibility and signage; for the private trails, Sultan's Planning Director, Andy Galuska, urged us to focus on connections between the new housing developments to make suggestions on which trails the city could potentially acquire. According to information provided by Andy and Nate Morgan, of Sultan Public Works, assessing the public trail system in Sultan was a greater priority for this project than examining the details of the private trails in the new developments.



ASSESSMENT TOOL

The assessment tool we created for the Sultan trail system was a combination of the Gehl Quality Criteria (Gemzøe, 2006) (Figure 1) and our own insights. From the Gehl Criteria, we chose to omit ‘possibilities for hearing/talking’ and ‘possibilities for play/unfolding activities’, and combined the three ‘protection’ categories under one heading. We also added indicators for signage and litter. After meeting with Nate Morgan from Sultan Public Works, we updated the assessment tool to include a heavier focus on signage at the trailheads and along the public trails, as well as ADA accessibility potential, per his suggestions.

The assessment tool we created includes nine indicators, and is based on a scale of Good, Needs Some Work, and Needs Significant Work (Table 1). The first indicator measured was protection against weather and traffic. Next, we measured walkability and ADA accessibility, defined as at least three feet wide with no large potholes or bumps. However, since no member of our team is physically disabled, we defined ADA accessibility as a

P R O T E C T I O N	1. Protection against Traffic & Accidents <ul style="list-style-type: none"> - traffic accidents - fear of traffic - other accidents 	2. Protection against crime & violence (feeling of safety) <ul style="list-style-type: none"> - lived in / used - streetlife - streetwatchers - overlapping functions - in space & time 	3. Protection against unpleasant sense experiences <ul style="list-style-type: none"> - wind / draft - rain / snow - cold / heat - pollution - dust, glare, noise
	4. Possibilities for WALKING <ul style="list-style-type: none"> - room for walking - uncluttered layout of streets - interesting facades - no obstacles - good surfaces 	5. Possibilities for STANDING / STAYING <ul style="list-style-type: none"> - attractive edges »Edgeeffect« - defined spots for staying - supports for staying 	6. Possibilities for SITTING <ul style="list-style-type: none"> - zones for sitting - maximizing advantages primary and secondary sitting possibilities - benches for resting
	7. Possibilities to SEE <ul style="list-style-type: none"> - seeing-distances - unhindered views - interesting views - lighting (when dark) 	8. Possibilities for HEARING / TALKING <ul style="list-style-type: none"> - low noise level - bench arrangements »talkscapes« 	9. Possibilities for PLAY / UNFOLDING / ACTIVITIES <ul style="list-style-type: none"> - invitation to physical activities, play, unfolding & entertainment - day & night and summer & winter
C O M F O R T	10. Scale <ul style="list-style-type: none"> - dimensioning of buildings & spaces in observance of the important human dimensions related to senses, movements, size & behaviour 	11. Possibilities for enjoying positive aspects of climate <ul style="list-style-type: none"> - sun / shade - warmth / coolness - breeze / ventilation 	12. Aesthetic quality / positive sense-experiences <ul style="list-style-type: none"> - good design & good detailing - views / vistas - trees, plants, water
E N J O Y M E N T			

Figure 1: Gehl Quality Criteria (Gemzøe 2006)

potential, not a strictly defined indicator. We also noted places to stop and rest along the trails, including bridges and benches. The visibility criteria included clear sightlines around corners, unhindered views, and lighting at night. We measured whether the trails were scaled to appropriate use, such as walking or running, biking, or driving. Positive aspects of climate included a balance between sun and shade, warmth and cold, and ventilation. Aesthetic quality of the trails was defined as the general cleanliness and maintenance. Our final indicator measured the presence, or lack thereof, of signage at the entrance, exit, and along the trails.

Trail Name:	Scale: Good - Needs some work - Needs significant work
Signage at trailheads, along the trail	
ADA accessibility potential	
Resting (opportunity to rest along the trail)	
Visibility (sightlines, lighting)	
Scaled to appropriate use	
Positive aspects of climate	
Aesthetic quality (cleanliness, maintenance)	
Litter and trash	
Protection against weather and traffic	

Table 1: Trails assessment tool

PUBLIC TRAILS

On our first assessment trip, we started on Susie's Trail then continued onto the North Loop. The lack of signage along both trails made it somewhat difficult to determine which trail we were walking until we reached the sign by the trailhead at Osprey Park. However, we were able to collect a significant amount of data on the Osprey Park trail system, as well as the evacuation trail by the high school. Using our scale of 'Good, Needs Some Work, Needs Significant Work,' we assessed the Evacuation Trail and High Street Trails, Susie's Trail and the North Loop, and the Middle and South Loops (Figure 2). Susie's Trail and the North Loop had the highest number of indicators rated 'Good', primarily because they were much more recently upgraded and maintained. The Middle and South Loops had the lowest number of indicators rated 'Good'. All three sets of trails we assessed 'need significant work' on signage. In terms of ADA accessibility potential, Susie's Trail and the North Loop were rated as 'Good', the evacuation and High Street trails 'need some work', and the Middle

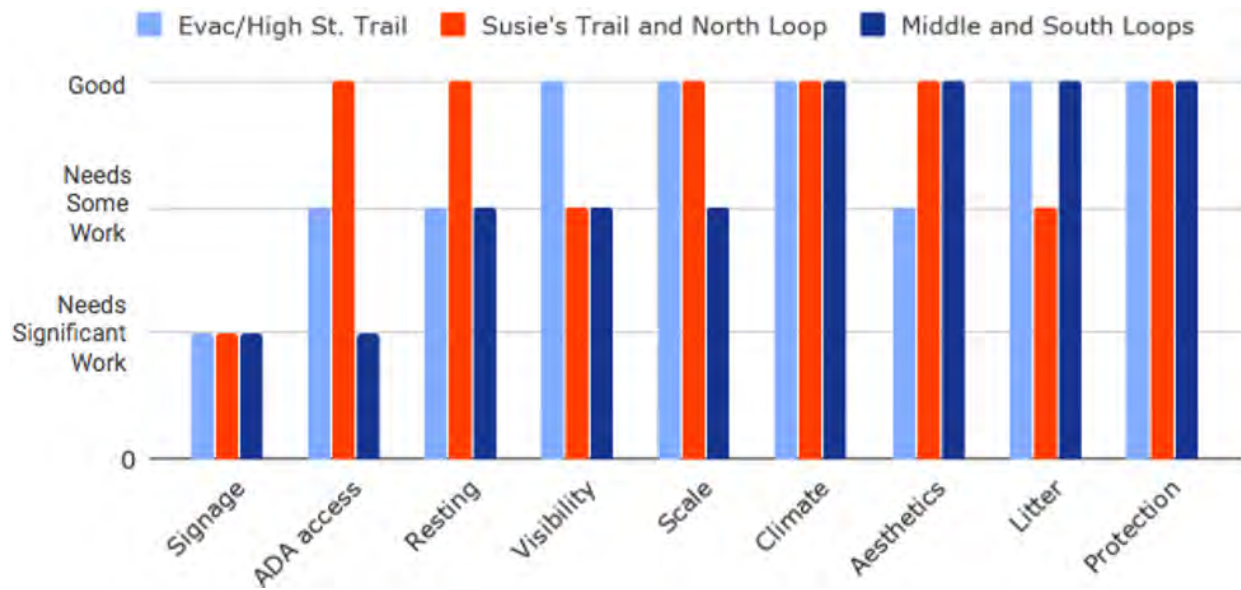

Figure 2: Public trails assessment data collected on November 8, 2019.



Figure 3: Osprey Park trails map marked with Waypoints.

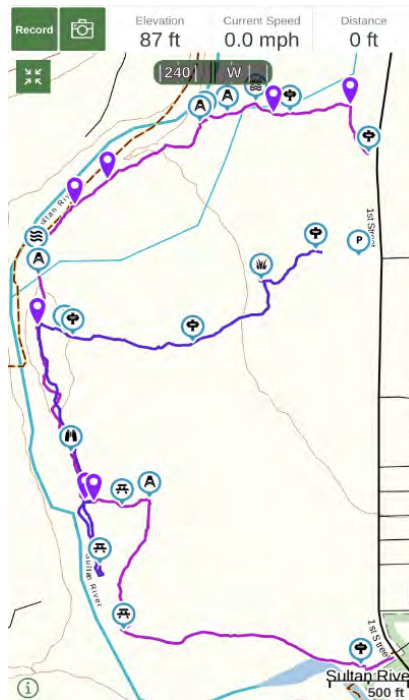

Figure 4: Marked trail features

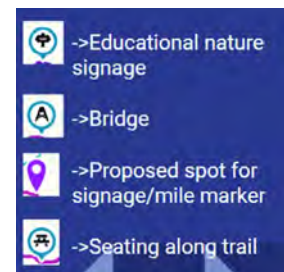

Figure 5: Legend

and South Loops 'need significant work' (Appendix 2). Figure 3 is a portion of the Osprey Park trail system mapped out on Gaia. Various features were inventoried using the waypoint feature. Figure 4 shows the waypoints represented with various icons in Gaia to marcate what sort of features can be found on the Osprey Park trail system. Purple waypoints indicate intersections where we felt could benefit from signage. The tower icon indicates bridges that cross over streams and the picnic bench icon indicates places to sit along the trail, approximate legend is featured in Figure 5.

ALTERNATIVE PEDESTRIAN PATHWAYS: EVACUATION TRAIL AND PRIVATE RESIDENTIAL TRAILS

Our main objective assessing the private residential trails on the East side of Sultan and the evacuation trail that connects the East to the West was less focused on inventorying their features but rather evaluating which ones the city should consider acquiring. Although the maps may seem to lack detail, the private resident trails simply did not have as many features to inventory compared to the Osprey Park trail system.

Sultan High School Evacuation Trail

This trail had good tread, and was wide enough to fit a vehicle. However, when determining its potential for ADA accessibility, we found that trail's grading was not pedestrian friendly according to the USFS and USDA

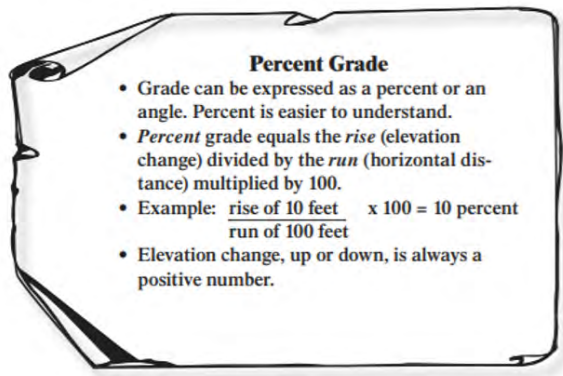

Figure 6: How to determine percent grade, image from USDA USFS Trail Construction and Maintenance Notebook

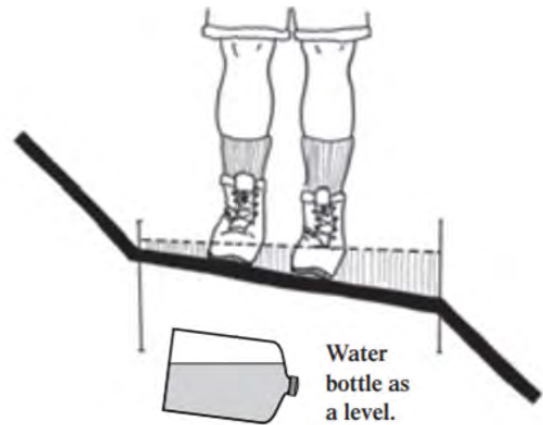

Figure 29—If your ankles start to roll, the tread has too much outslope.

Figure 7: Ankle Roll Test

Trail Construction and Maintenance Guide. According to the 2007 edition of the guide, grading uphill or downhill should be less than 10 percent (USDA 2007). Figure 6 explains how to determine grade. The USDA USFS Trail Construction and Maintenance Notebook suggests an easy way to gauge whether or not the trail grade is under 10 percent is seeing whether or not one's ankles start to roll when standing perpendicular to the trail (See Figure 7). Other opportunities we saw for improvement was the need for street lighting and signage. Considering the trail is a major pedestrian pathway to get from the East side of Sultan to the West side, we propose that the city should be managing this trail.

PRIVATE RESIDENTIAL TRAILS

Similar to the evacuation trail, we found that the Wildwood Trails Neighborhood to Dogwood Ct trail (green route in Figure 8) was lacking in good lighting and needed improvement in tread. It is relatively well graded



Figure 8: Map of private residential trails



and has the potential to be ADA accessible. The Daisy's Landing to Highway 2 trail (orange route in Figure 8) also has poor grading as well as poor drainage. Proper lighting would also be a necessary addition for consideration of Sultan's acquisition.

After assessing these trails we propose that the city of Sultan consider taking over management of the green and orange routes marked in Figure 8. This would create a North to South running public pedestrian trail. These trails can connect residents living in the various housing developments on the East side and have the potential for ADA accessibility. We decided to not include the dark blue and light blue routes in this proposal because they are internal residential neighborhood trails.

PARKS ASSESSMENT AND INVENTORY

ASSESSMENT TOOL

After reviewing what the City of Sultan asked us to find out about their parks and a few additional parks assessment tools, it became clear we needed to create our own assessment tool. We drew from three documents to create this specialized assessment tool, each listed below.

SULTAN PROS PLAN

This document lists the existing facilities, amenities, and proposed improvements for each of the city's parks as of 2010. This was a useful starting point, but needed amendments and additions based on our updated demographic analysis. This tool was the base to which we added elements from other assessment tools (City of Sultan 2010).

WALKABILITY AUDIT

This tool focuses solely on the pedestrian experience in an area. Some of the tools in the Walkability Audit could be useful additions to the trails assessment. For example, an adapted version of the Pedestrian Facilities, Maintenance, Universal Accessibility, and Aesthetics ratings would be a worthwhile addition to the trails assessment tool as well as the parks assessment. Also something like the the written observations portion of the assessment tool, especially like question number 5 ("Are the conditions of this segment appropriate and attractive or exercise and or recreational use?"), would also be useful to add (Dannenberg, Cramer & Gibson 2005).

GEHL QUALITY CRITERIA

Gehl splits their criteria into three sections; Protection, Comfort, and Enjoyment. Most of the parks the Gehl focused on were in more urban spaces and didn't have the same concerns as Sultan parks. For instance, Sultan is concerned with sports fields, which the Gehl has an assessment does not address. However, many other other assessment sections (Protection against traffic, Protection against violence, Possibility for walking/sitting/playing, and Possibility for enjoying the positive aspects of climate) could be very useful for assessing Sultan parks (Gemzøe 2006).



INITIAL PARKS AND TRAILS ASSESSMENT

From these sources we were able to create the parks assessment tool below:

Park:

Date:

Assessor's Name:

(Rating Questions)

Safety from automobiles/traffic
(needs significant work).....(needs some work).....(good)

Personal Safety (sightlines, lighting, etc.)
(needs significant work).....(needs some work).....(good)

Pedestrian Access
(needs significant work).....(needs some work).....(good)

Activities
(needs significant work).....(needs some work).....(good)

Universal Accessibility
(needs significant work).....(needs some work).....(good)

Maintenance
(needs significant work).....(needs some work).....(good)

Access to Nature
(needs significant work).....(needs some work).....(good)

Notes:

(Observation Questions)

Describe the surrounding area.

What are the possible activities? (Sitting, walking, play/unfolding activities, ect.)

Does this park feel safe? If so, why? If not, why not?

(List and tally amenities (name of amenity/relative condition -- adequate, needs some work, needs significant work), defined as any intentional feature that provides, comfort, convenience, and pleasure)

Amenity type	Tally	Condition
(example)		
Benches	3	needs some work

Figure 9: Parks Assessment Tool

PARKS ASSESSMENT

Using our tool we assessed every park listed in the Sultan PROS Plan, and created corresponding profiles for park. We must highlight that our assessments spanned over the months October through December, which is “off-season” for parks, where they are not as meticulously maintained or as frequently visited as in warmer months. Also, it is important to acknowledge that some parks are developed with expectations to meet different needs, which is visible on the assessment tool in the variation of scores for certain needs.

Rudolf Reece Park

Bench	3	good
play structure	1	good
baseball field	1	needs some work
baseball fence/backstop	1	good
soccer goals	1	needs some work
shelters	2	needs some work
grills	4	needs some work
trash/recycling	5	good
bathrooms (M/W)	1	good
water fountains	1	needs some work
open fields	1	needs some work
parking lots (medium-sized)	1	needs some work
lights	12	needs some work
soccer fields	0	n/a
bleachers	2	good
basketball hoops	0	n/a
bike rack	0	n/a
picnic table	5	good
skate structure	0	n/a
fence	0	n/a
signs (general about park)	2	good
amplitheater type stadium bl	1	good
dog poop station	1	good
heater stove	0	n/a
landscape/historic display	0	n/a
	10	Good
	8	Needs Some Work
	0	Needs Significant Work

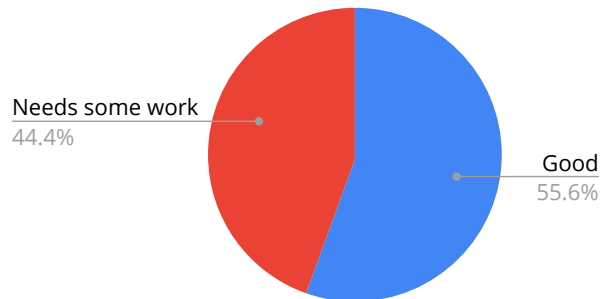

Rudolf Reece park is one of the two larger, main parks in Sultan. This space has potential for increased utilization, because of its size, developed and well-maintained open spaces, access to nature and the river, and established paths for people and cars. We felt the pedestrian safety is adequate since it is removed from any main roads, though this comes with a challenge of being removed from the center of the city. There is no pedestrian access connecting other parts of Sultan to Reece park—the only way to get to the park is via car, and the park lacks clearly identified parking spaces.

The park’s developed areas provide multi-use functions, which include the shelters, baseball field, play structure, open field for soccer, and bathrooms. Although the soccer field isn’t official-size, and can’t be used for team practices, the park provides a high-quality space for all casual interests. Additionally, individuals are right near the river and can experience nature surrounding them, but this feeling comes with a cost of decreased sight lines within the park. During parts of our visit the park felt unsafe due to such poor sightlines, the timing of dusk turning to evening, and the seclusion of the park.

Osprey Park

Bench	5	good
play structure	1	needs some work
baseball field	1	needs some work
baseball fence/backstop	1	needs some work
soccer goals	10	needs some work
shelters	1	good
grills	0	n/a
trash/recycling	4	good
bathrooms (M/W)	1	needs some work
water fountains	1	good
open fields	0	n/a
parking lots (medium-sized)	3	good
lights	6	good
soccer fields	2	good
bleachers	2	good
basketball hoops	2	needs some work
bike rack	2	good
picnic table	6	good
skate structure	0	n/a
fence	0	n/a
signs (general about park)	3	good
amplitheater type stadium bl	0	n/a
dog poop station	1	good
heater stove	0	n/a
landscape/historic display	0	n/a
	10	Total "good"
	6	Total "needs some work"
	0	Total "needs significant wor

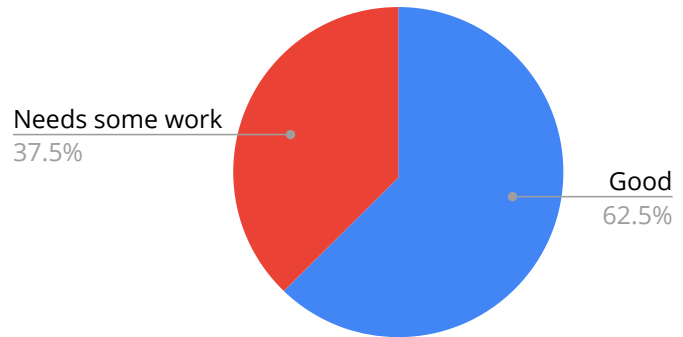

Osprey is the largest and busiest park in Sultan. The majority of the amenities in this park were in good condition, but there are a few areas for improvement. For instance, when we walked the trails we got lost a few times, and also ran into other lost walkers along the path. Signs throughout the trails and open spaces would help orient users, encouraging walkability. Additionally, the well-utilized sports fields and play structures and other amenities could use maintenance. For example, the play structure seems generally sound but could use some repairs and because it is small, serves only younger children.

Skate Park

Bench	0	n/a
play structure	0	n/a
baseball field	0	n/a
baseball fence/backstop	0	n/a
soccer goals	0	n/a
shelters	0	n/a
grills	0	n/a
trash/recycling	1	good
bathrooms (M/W)	1	good
water fountains	0	n/a
open fields	0	n/a
parking lots (medium-sized)	0	n/a
lights	0	n/a
soccer fields	0	n/a
bleachers	0	n/a
basketball hoops	0	n/a
bike rack	0	n/a
picnic table	1	good
skate structure	1	good
fence	1	good
signs (general about park)	0	n/a
amplitheater type stadium bleachers	0	n/a
dog poop station	0	n/a
heater stove	0	n/a
landscape/historic display	0	n/a
	4	Total "good"
	0	1 "needs some work"
	0	0 "needs significant work"

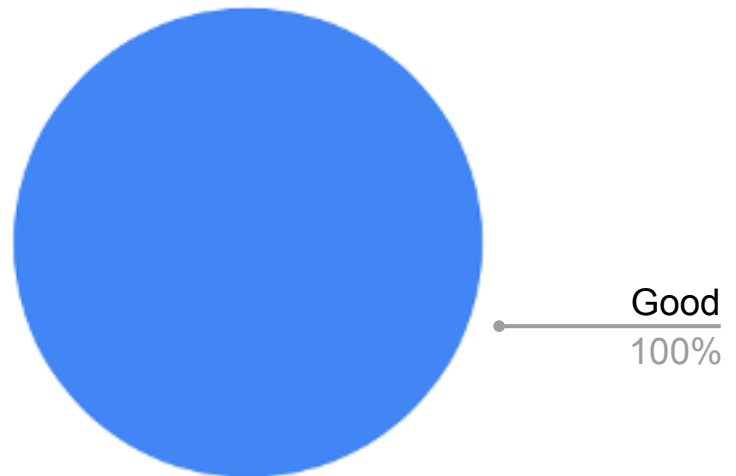

This park also seemed well utilized and busy during our visit. This space provides a safe space for residents to skateboard and rollerblade as well as a gathering space. Because of this we saw that some of our criteria, such as 'Access to Nature' wasn't applicable. We did our best to assess the park while considering its services. All things considered, the amenities are in good condition, but recommend moving the trash can to a clearer location and building permanent bathrooms.

Riverside Park

Bench	0	n/a
play structure	0	n/a
baseball field	0	n/a
baseball fence/backstop	0	n/a
soccer goals	0	n/a
shelters	1	good
grills	0	n/a
trash/recycling	5	good
bathrooms (M/W)	0	n/a
water fountains	1	good
open fields	0	n/a
parking lots (medium-sized)	0	n/a
lights	0	n/a
soccer fields	0	n/a
bleachers	0	n/a
basketball hoops	0	n/a
bike rack	0	n/a
picnic table	2	good
skate structure	0	n/a
fence	0	n/a
signs (general about park)	0	n/a
amplitheater type stadium bl	0	n/a
dog poop station	0	n/a
heater stove	0	n/a
landscape/historic display	1	good
	5	Total "good"
	0	al "needs some w
	0	'needs significant

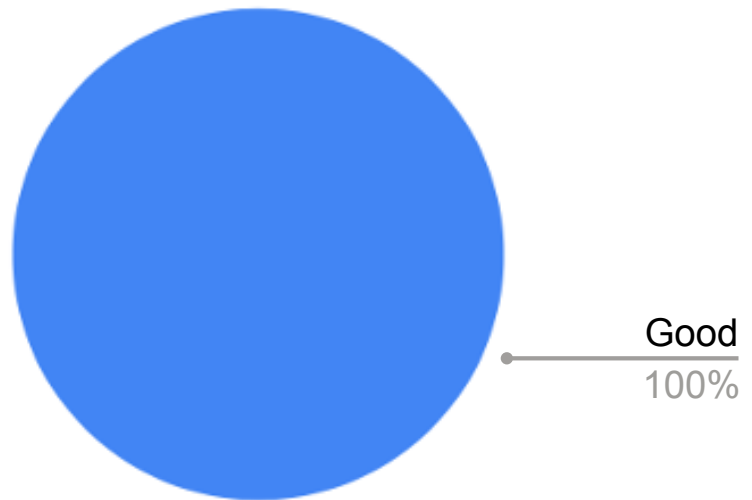

Despite the ongoing construction, we assessed Riverside Park as best we could. This park's assets include the gazebo structure, access to the river, open space, and access to Suzies Trail. We found that all of the amenities in this park were in good condition, but some of the trash cans are unmarked and the only bathroom was a temporary portable one (we thought this might be due to construction, which is why they are not addressed in the table).

Sportsman Park

Bench	0	n/a
play structure	0	n/a
baseball field	0	n/a
baseball fence/backstop	0	n/a
soccer goals	0	n/a
shelters	1	needs some work
grills	0	n/a
trash/recycling	3	good
bathrooms (M/W)	0	n/a
water fountains	0	n/a
open fields	0	n/a
parking lots (medium-sized)	0	n/a
lights	0	n/a
soccer fields	0	n/a
bleachers	0	n/a
basketball hoops	0	n/a
bike rack	0	n/a
picnic table	1	good
skate structure	0	n/a
fence	0	n/a
signs (general about park)	3	good
amplitheater type stadium bl	0	n/a
dog poop station	1	good
heater stove	1	good
landscape/historic display	0	n/a
	5	Total "good"
	1	1 "needs some w
	0	'needs significant

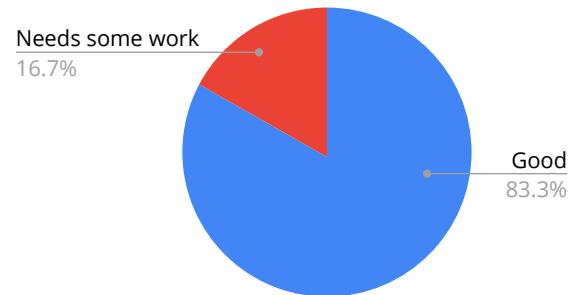

Here we were struck by the contradiction of direct access to the river despite its proximity to Highway 2. There is a good range of activities offered, such as playing in the open fields or using the heater stove in the shelter. There is also ongoing construction here for the pedestrian bridge. The shelters could use some maintenance and the signs leading to the park are worn, but otherwise amenities are in good condition.

Cemetery Ball Fields

Bench	0	n/a
play structure	0	n/a
baseball field	1	needs some work
baseball fence/backstop	1	needs significant work
soccer goals	0	n/a
shelters	0	n/a
grills	0	n/a
trash/recycling	1	needs some work
bathrooms (M/W)	0	n/a
water fountains	1	needs some work
open fields	0	n/a
parking lots (medium-sized)	0	n/a
lights	0	n/a
soccer fields	0	n/a
bleachers	0	n/a
basketball hoops	0	n/a
bike rack	0	n/a
picnic table	0	n/a
skate structure	0	n/a
fence	0	n/a
signs (general about park)	1	needs some work
amplitheater type stadium bl	0	n/a
dog poop station	0	n/a
heater stove	0	n/a
landscape/historic display	0	n/a
	0	Total "good"
	4	total "needs some work"
	1	al "needs significant work"

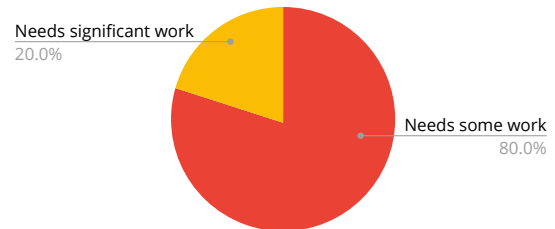

The open field here could become a high-quality baseball field. The current baseball field is in decent condition (mostly a lot of small mounds scattered throughout), and could easily become a quality field. The established parking spaces are easily accessible, which is important because most park-goers will need to drive there. Cemetery Ball Fields is relatively hidden, so we suggest more signage on the highway and within the park. Furthermore, this park serves Sultanites that don't frequent the parks closer to the city center. Improvements we suggest prioritizing include: the fence and backstop for the baseball field, smoothing the road leading to the baseball field, and clarification of park boundaries.

Traveler's Park

Bench	Count	Condition
play structure	1	good
baseball field	0	n/a
baseball fence/b	0	n/a
soccer goals	0	n/a
shelters	0	n/a
grills	0	n/a
trash/recycling	0	n/a
bathrooms (M/W)	1	good
water fountains	1	needs some work
open fields	0	n/a
parking lots (med	0	n/a
lights	0	n/a
soccer fields	0	n/a
bleachers	0	n/a
basketball hoops	0	n/a
bike rack	0	n/a
picnic table	0	n/a
skate structure	2	good
fence	0	n/a
signs (general at	0	n/a
amplitheater type	1	good
dog poop station	0	n/a
heater stove	1	good
landscape/histori	0	n/a
	3	good
	7	Total "good"
	1	il "needs some w
	0	'needs significant

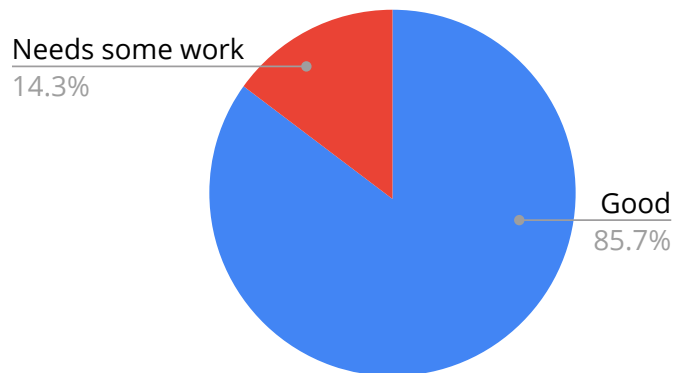

Traveler's Park is one of the best maintained parks. It is clean and spatially well defined by the road and railroad, but has adapted as well to this challenge. We acknowledged the inclines to the railroad and highway but feel there could be even more of a boundary to assist in safety. The assessment tool prompts commentary on pedestrian access to the park, but Traveler's park is intended as a rest stop by off of the highway. Within the park there is good open space for individuals to walk around, but more defined parking and more thoughtful location of the trash can and picnic tables will help improve the park.

FINDINGS

Here, findings from each park are consolidated into an overview of the amenity conditions, demonstrating the overall state of Sultan’s parks. As illustrated in the following chart, on the whole Sultan has acceptable conditions of their park amenities, with a majority 65.6% assessed “good” level, 32.8% needed “some work,” and 1.6% needed “significant work”.

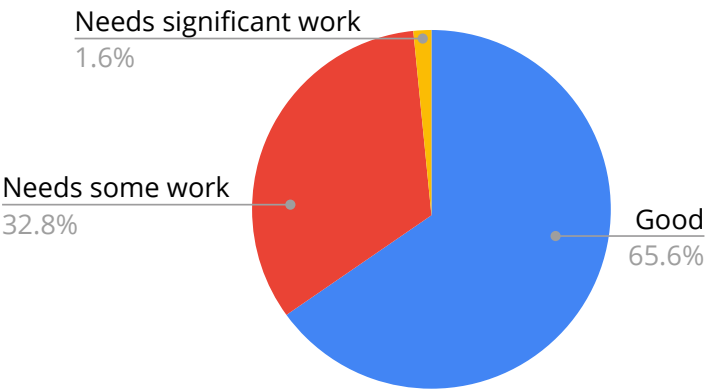

Chart 1: Overview of Amenity Conditions

Comparison

Research	vs	Sultan
55.1 acres		168 acres
58 acres		168 acres
12.5%		6%

Table 2: Land Comparison

The figure above shows the comparison of land recommended for parks based on the population of a city and the amount of land that Sultan has dedicated to parks (specifically the parks we assessed -- not including the parks attached to schools). The first row is looking at the amount of land proposed by the National Recreation and Park Association, which states that there should be at least 9.5 acres of parks for every thousand residents of a city. For Sultan that would mean a total of 55.1 acres of parks. As seen in the figure above Sultan has more than triple the amount of parks recommended by the NRPA.

The American Planning Association on the other hand recommends at least one acre of parks for every 100 residents of a city. This would mean 58 acres of parks in Sultan, which again Sultan handily surpasses.

Lastly Charles Downing Lay, the landscape architect for the New York State Department of Parks in 1914, theorized that every city should have 12.5% of its land dedicated to its parks. This is the only metric we found where Sultan falls short with only about 6% of its land dedicated to parks.

As these measures show, Sultan does have a significant amount of park land to serve its residents. However, with new residents coming in and expansions to parts of the town, it is important that Sultan considers adding new parks to serve these new residents.

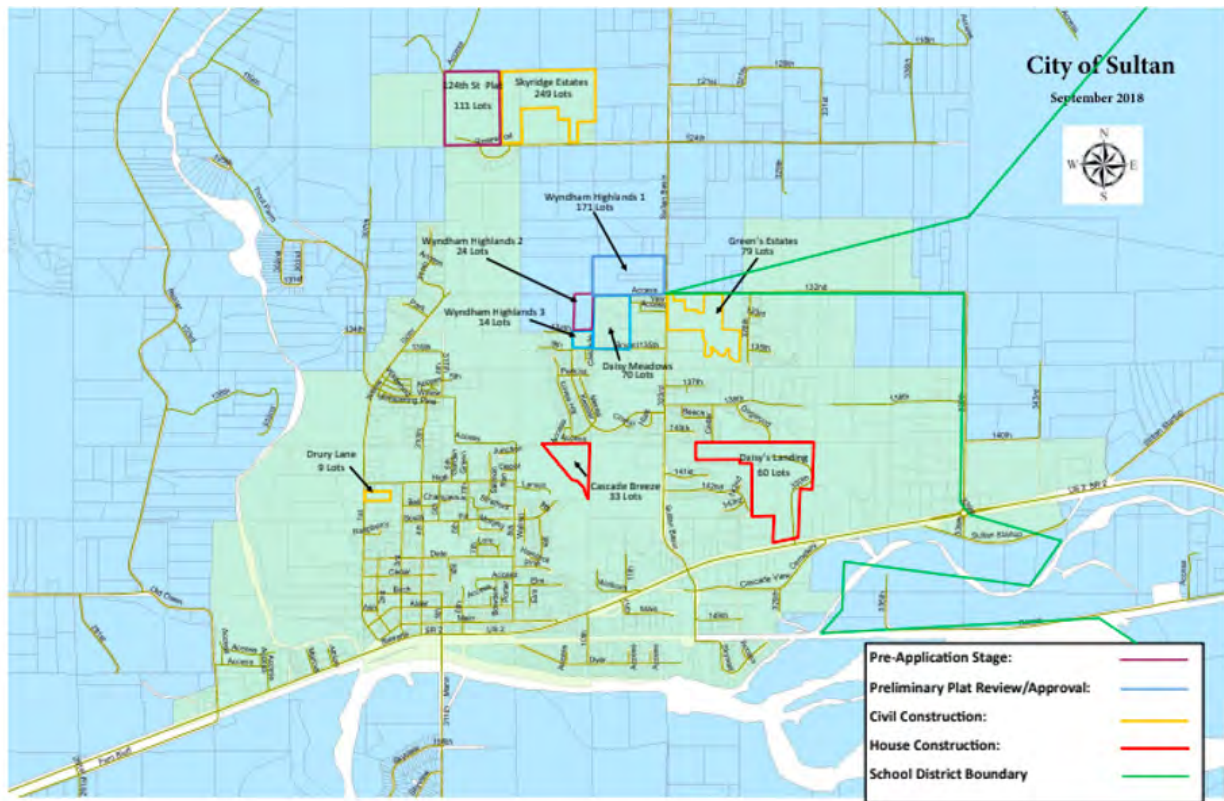

Figure 10: Map of Development

FUTURE PARK DEVELOPMENT

During the parks analysis, we also surveyed two additional sites for future park development. These will be referred to by their colloquial names “Hammer Property” and “County Gravel Lot.” County Gravel Lot poses more than one issue, being that the lot is owned by Snohomish County, who has no active plans for the property, but is in no hurry to let the property go. At one point, the asking price was more than 10x what it was actually worth. On top of that, it is far away from the majority of the development happening in Sultan, and is on a one lane road with one point of ingress/egress. To top it all off, the majority of the ground is gravel, making for a good playground flooring, but not for any other type of programming. We came to the conclusion that this property would not make for a good park for the above reasons.

Next, we surveyed the hammer property, which is already owned by the City of Sultan, and has some potential for programming space. There is access to Highway 2, which provides the much-wanted intercepting of cars passengers to stop in Sultan. It is also located in one of the newer housing developments, providing immediate usership. However, because it is located in the housing development, some questions could be raised about how public the park would really feel. Also, a large portion of the property is a steep slope and is thus unusable and unprogrammable. The best use of this property may not be to place a park here.

Finally, during our final presentation, Will Ibershof, City Administrator for the City of Sultan, detailed another parcel that may be used for park space. More research should be done into this parcel as LCY continues and should be included in the final report.



COMMUNITY ENGAGEMENT

METHODOLOGY

The community engagement team aimed to connect with Sultan residents to learn how Sultan's parks and trails are currently used and if their needs are being met. In order to understand their wants and needs, we used three primary methods to seek out feedback from Sultan residents; site visits, community discussions and surveying.

Our first site visit to Sultan was October 13 before the official start of the Livable City Year partnership. Our intention was to explore Sultan and walk some of the trails and parks to get a sense of the space and the community. October 28 was our team's formal site visit where we got a tour of Sultan's parks and trails from Nate and Andy. This was an important visit which gave us a better understanding of the size and conditions of each public facility. As a community engagement team, this was a great opportunity to learn more of the community dynamics and the existing knowledge gap between city staff and the public. On November 20, our team visited Sultan to more directly engage with the citizens. We visited several community centers including the senior center, the boys and girls club building, the visitor's center, the library and Sultan Elementary School. In these visits we received direct insight on what residents would like to see in their parks and trails system.

In addition to our visits, we developed personal connections with residents through other various outreach efforts. These included our intercept surveys, the Trunk or Treat event, senior center discussions and kindergarten class activity. Our purpose during these events was to get ourselves out in Sultan in order to start opening discussions about what residents want from their parks and trails. Establishing relationships with residents was a key part of our community engagement efforts.

Lastly, we sought input from residents through the use of surveys. Our online Google survey was a useful way for us to collect individuals' thoughts. There are a total of twelve questions aimed at understanding the respondent's satisfaction with existing parks and trails in Sultan and what new ideas they have for improving these areas. The survey was disseminated online via private Sultan-based Facebook groups, the City of Sultan Facebook page and the City of Sultan website. Physical copies of the survey were dropped off and collected in the senior center, the library and the city hall office. Additionally, we posted many flyers around Sultan which advertised the survey and included a tear-off link.

INTERCEPT SURVEYS

During our first visit to Sultan, we conducted several spontaneous intercept surveys in Osprey Park asking people why they use Sultan's parks. It was Sunday, October 13th; a partly sunny and partly overcast late morning when they took place. We witnessed five people in total using the trails in Osprey, two couples and one jogger. The first people we saw using the trails in Osprey was a couple who live right outside of Sultan but they use the parks regularly to walk and they enjoy watching the salmon population. Next, we ran into a couple who was walking their dog and who also use Osprey regularly as they live in Sultan. They are specifically into bird watching and bird photography in Sultan's parks. They mentioned that they do not typically see a lot of people at Osprey. These intercept surveys were an initial and informal way to help us get a sense for the community attitude around Sultan's open spaces and trails and was an easy way to talk to the people in Sultan.

TRUNK OR TREAT

Trunk or Treat is an annual “community-building event meant to provide families with a safe and fun place to go trick-or-treating.” (Sultan Community Alliance, 2018). Attending this event and engaging with the community was an important goal for the Sultan Community Engagement team. We viewed this outreach as a “temperature check,” because we knew that the pace of the event was fast and that we would not have a large amount of time to talk to residents.

We used two flip chart easels to make it easy for people to approach our table to grab some candy and place a sticker on their favorite park or trail and how often they use such parks and trails. The questions read, “How often do you use Sultan trails and parks?” and “What is your favorite trail or park in the area?” As you can see in the chart below, we had 150 total responses to the first question. The second question, received 176 total responses and a vast majority, 123 people, said that they use Osprey the most. We also recorded the “other” responses that we received from people in order to gauge what other parks or open spaces we should be considering. These findings are shown in the third chart, below. The most popular responses we received were Skate Park and “my backyard.” A response that stood out to us in particular was, “I’ve been here for two years and never knew there were trails at Osprey.” We can use these findings to conclude that the parks and trails in Sultan are not being used to their fullest potential.

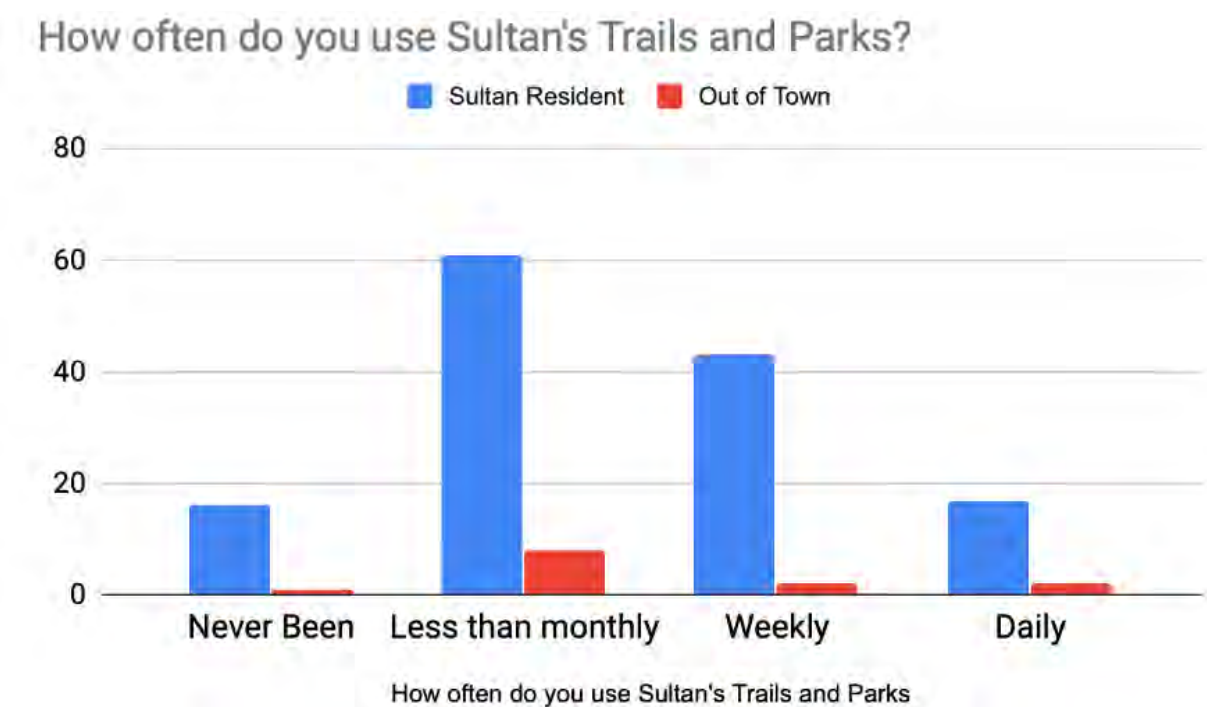

Chart 2: Trunk or Treat Flip Chart Responses

What is your favorite park/trail in Sultan?

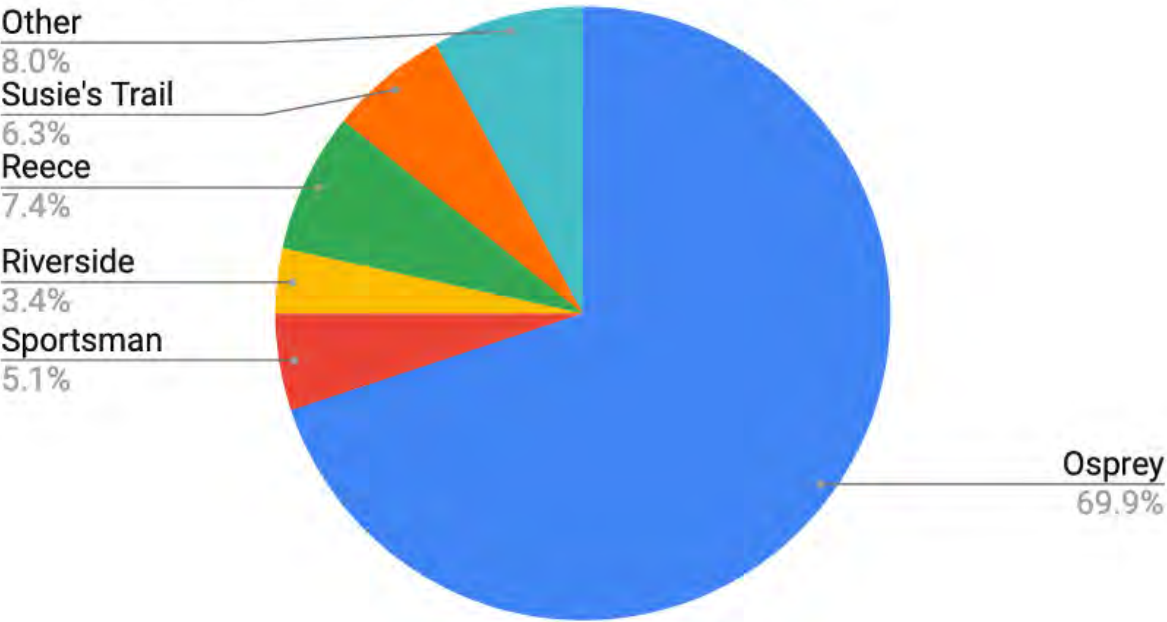

Chart 3: Trunk or Treat Flip Chart Responses

Other Responses

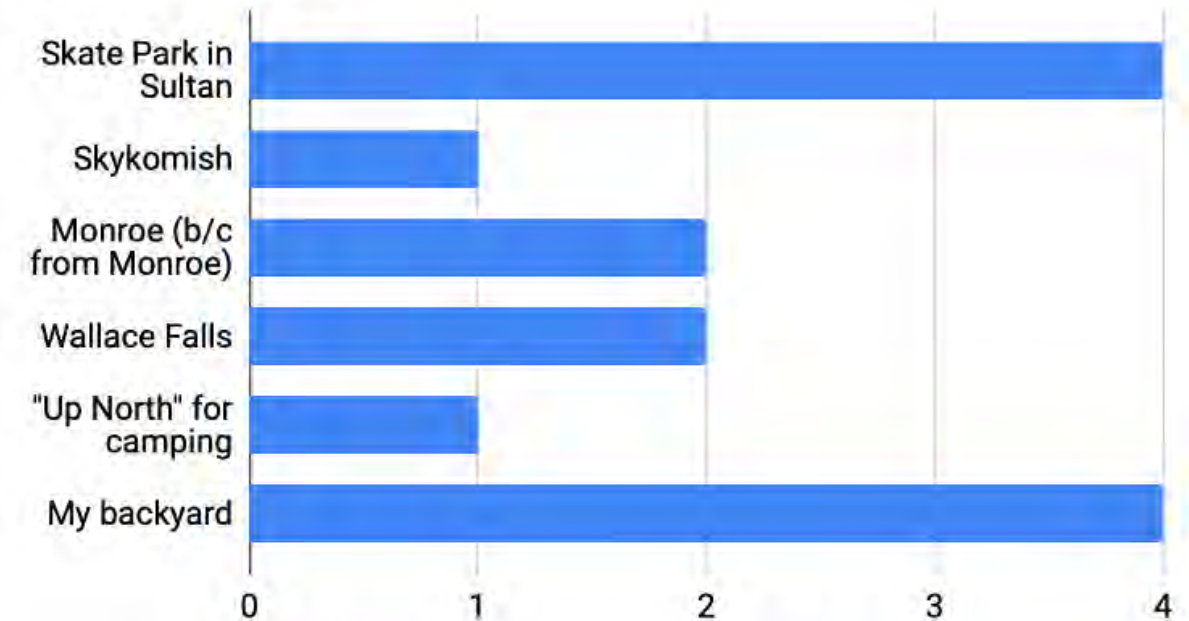

Chart 3: Trunk or Treat Flip Chart Responses



In addition, we discovered at the event that residents of Gold Bar have been considering themselves Sultan residents. For our questions, we had Sultan residents use red dots to answer and everyone else use brown. It was not until about halfway through Trunk or Treat that we realized some Gold Bar residents had been using red dots. This finding revealed that Sultan carries a strong identity even among neighboring cities.

However, after presenting our results from Trunk or Treat during the midterm presentation, we got feedback from Mayor John Seehuus that he really only wanted to know what Sultan residents want — which excludes people from Gold Bar or elsewhere. We took this and had our next survey ask residents to identify where within Sultan they live. One of the answers included an option that read, “I do not live in Sultan (I live in Gold Bar, Monroe, etc)” so we could be sure to exclude those responses.

Trunk or Treat was a great event and an opportunity to meet hundreds of Sultan residents in a fun and informal way. We got our name out there and explained our purpose in partnering with LCY and the City of Sultan. Overall, people seemed happy to meet us and learn about our project, but the main takeaway from this event was that many people were not familiar with the names of the parks and quite a few did not know where the various parks were located in Sultan.

FLYERS

Our team also wanted to reach people who would not find our surveys via online resources. To do this, we created paper flyers that we posted in the Sky Valley Senior Center, the Sultan library, the visitor center, the Boys and Girls Club, the Volunteers of America building, and in a public flyer display on main street. Because the survey is mainly online, the flyer featured tear-off portions with the link to the online survey. Looking back, we could have also included on the flyer that there were paper copies available at the library front desk for those who do not have access to a computer. We wanted to engage with the community through as many platforms as possible.

SURVEY RESULTS

Overall, we received 88 responses on our online survey as well as a few paper copies from the Sky View Senior Center participants. We included 12 questions pertaining to opinions of the current parks and trails in Sultan and including other information about them, the only required question being one asking participants where they live. Using this question, we excluded 12 results from the respondents who did not live in Sultan, but noted some of their information in order to better create surveys in the future.

The largest age group of participants was 36-45 with 26 responses, followed by 22 responses from 26-35 year olds, 20 from those 56+, and 14 from 46-55 year olds. Most respondents live in Sultan, 51 saying that they lived in the downtown region with 18 of those responses specifying that they lived West of Sultan Basin Road, and 33 saying they lived downtown. Seventeen responses said they lived East of Sultan Basin Road, in the Basin, while the rest lived South of the river.

Generally, Sultan’s trails ranked better than the parks. On a scale of one to four, one being poor (needing repairs, outdated, etc.) and four being great (no complaints); 63% of responses gave a three or higher for trails, while the parks had just under 50%. The reasoning for low rankings being a concern for safety and poor condition.



Of the 46 people who expressed a concern for safety, 27 of them mentioned houseless people and encampments being a concern. Several responses included sightings of needles, empty alcohol bottles, and drug use in public areas. 22 of those who expressed a concern for safety also noted the poor conditions of the parks and trails. When asked if Sultan would benefit from more parks, 75% of people responded saying yes, 16% said no, the remaining 9% said that new parks would be great but that existing parks needed an upgrade before more parks were put in.

Close to two thirds of all respondents mentioned something about their children and families using parks and trails. Many of these were expressed through safety concerns of old playground equipment and the lack of playgrounds in the area. One response said “it’s scary when they are 2 to 4 [years] old climbing on 2 story structures”, while another said that it’s challenging to explore parks with their 10-month-old son because there isn’t any play equipment that they can explore along with him. Several other expressed their unease at walking through some trails with their children because of poor lighting, as well as other trash and needles lying around. One response even mentioned that they had seen toilet paper and excrement strewn along an Osprey Park trail.

When it came to asking the question of where new parks and trails were wanted, 94% had a response to where new parks could go, but only 58% responded with a suggestion as to where new trails could go. This could be because it was the second to last question, however many people who left it unanswered shared additional comments for the last question. We think that the reason for this is that people can’t make suggestions if they don’t know where the trails are in the first place, which is another trend that we saw in these results. 11 people mentioned wanting better signage for trails and including maps, 2 people suggested having more art and history along trails and in parks. This may be a good way to get more people outside using Sultan’s amenities if it can teach children and visitors about Sultan’s “rich history” as one response says. Twenty-eight percent of responses said they wanted new parks to be located on the East side, while 24% specified “near a river.” Many other responses also mentioned wanting new amenities near a river, along the mountainside, or in a location with a view of the sunset or sunrise.

Judging by some of the very thorough responses from our survey, as well as some of the personal encounters we had with Sultan residents, it seems that many community members are really looking forward to the improvements and have loved being a part of the creative process so far, even if it just filling out a survey. We pulled out some notable quotes that we thought showcased some common concerns among the responses, as well as some that had creative suggestions to commonly seen problems [Appendix 3].

Access to the Google survey results can be requested and arranged. Please contact LCY to connect to our team for details.

KINDERGARTEN CLASS VISIT

The youth population in the City of Sultan is perhaps one of the most important stakeholders for parks. Because of this, we wanted to reach out to the students at Sultan Elementary School so that they could participate in a brainstorming activity and feel like a part of the parks planning process. We accomplished this by reaching out to Kelly Flynn, a kindergarten teacher at Sultan Elementary School, and we set up a time to



come in and lead an activity. Our visit consisted of a brief presentation that had images of creatively designed parks from all around the world, followed by an activity where the kindergarteners were asked to draw their dream park.

While the children were drawing their parks we asked them questions about the different elements in their drawings. Out of the 18 drawings from the 18 students in the class, 12 included slides, 9 included water elements (pools, waterslides etc.), 6 included greenery (trees, shrubs, bushes etc.), 6 included rainbow/lots of color, 5 included monkey bars, and 4 included swings. We found it interesting that so many kids included water elements in their drawings, and the more we thought about it the more we began to understand a potential reason why. Sultan is surrounded by the Skykomish and Sultan river, however these rivers are usually too cold and too dangerous to swim in. Because of this, we began to build the assumption that the kids in Sultan are longing for a place to swim/splash due to the restrictions against swimming in the water that they can see all around them.

Although the data we gathered from this kindergarten class is not representative of the entire youth population in Sultan, we found it important engagement with a part of the community that may otherwise have been left out of discussions regarding park/open space development. It was amazing to see the excitement and creativity fostered within the youth culture in the City of Sultan.

SENIOR CENTER LUNCH

The Sky Valley Senior Center, located in Sultan, has lunches open to the public every afternoon, Monday through Thursday. As a community engagement team, we were excited that we got the chance to visit during one of these lunches on November 20th because we wanted to gather input from a diverse range of folks who use Sultan parks and trails. Unfortunately, this visit was not as productive as we had initially planned it would be. There did not seem to be a lot of interest in our project from the seniors at this lunch so we did not stay for a prolonged time. We briefly chatted with each senior to explain our project with LCY and the City of Sultan and asked them to fill out our satisfaction survey.

We brought many paper copies of the survey with us and we left extras around the lunchroom with pens so that people could fill them out at their leisure. Then, we returned a couple hours later to pick them up. We found that only five copies had been filled out when we returned. This was a smaller number than what we hoped to receive from the approximately 25 people eating lunch there when we first dropped the surveys off. So, for future reference, a structured activity or a facilitated discussion could have been more useful in generating greater interest and more feedback from this population.



RECOMMENDATIONS

GEOGRAPHIC INFORMATION SYSTEMS

Since the web app has the potential to be a useful asset for Sultan residents and city staff, we recommend continuing to update it. We believe it would be beneficial to add as much information as possible about Sultan's trails and their conditions into the app.

TRAILS ASSESSMENT AND INVENTORY

Given the timeline of this project we were only able to assess private residential trails that run north to south. For the next LCY cohort we highly suggest investigating private residential trail routes that run east to west, as well as looking into United States Forest Service (USFS) trail accessibility guidelines (<https://www.fs.fed.us/sites/default/files/FSTAG-2013-Update.pdf>). The USFS also provides a guide which includes a flowchart that can be taken into the field to evaluate accessibility (<https://www.fs.fed.us/sites/default/files/FSTAG-Pocket-Guide.pdf>).

We recommend creating walkshed maps around the public and private trails in Sultan to better determine who might be able to access the trails, and to point out routes between trails, especially within the new developments off of Sultan Basin Road. Walkshed maps should be developed at both the larger city level and at the individual housing development level to understand proximity and use of the trails in Sultan.

Lastly, we suggest looking at trails assessments that other cities of similar size to Sultan are currently using or have used in the past. These may provide insight into a more robust assessment tool.

PARKS ASSESSMENT AND INVENTORY

We recommend taking the data and observations that we collected and using it to help identify the highest priority projects in the parks and help enact them. For instance, the replacement of the play structure in Osprey. Additionally we assessed and gathered data so that the findings could be used to create something similar to an updated Sultan PROS plan. In some of our feedback from Sultan representatives we heard that lighting and safety was a concern in the parks. We also noted that many of the parks would benefit from outdoor lighting in the written part of our assessments, but were not able to do an in-depth assessment of what lighting would be most beneficial. A possible next step in this project would be to do a more in-depth assessment and create a plan for improving the lighting around the parks.

COMMUNITY ENGAGEMENT

Recommendations for future community engagement work include narrowing down the specific needs of the community, continue cultivating the relationships we established and broadening our outreach. It is important to adjust the type of engagement and outreach done to bring in a wide range of views. Some community groups like senior citizens and children responded well to in-person engagement. Middle-aged people in Sultan interacted very well with surveys. The surveys we were able to do was a great way to start gathering information. We did not get a chance to do as many intercepts surveys as we would have liked but we found that they were very effective in reaching the population of Sultan that is very familiar and comfortable with the trails and parks.



The outreach we were able to do gave us general ideas for needs of the community. The biggest concern that was brought was safety, however, safety is a very general concept. We need to follow up with residents to understand what is contributing to this fear. Understanding how residents of Sultan define safety for their parks is crucial for future work. A question was raised if adding lights to parks and trails would drastically change the feeling of safety, questions such as these should be made to the residents of Sultan. Once we have a better understanding of how residents of Sultan define safety then we will be able to offer specific recommendations.

We also realized that signage was a big issue, the next steps include finding signage that best fits the needs of this community. Our trails assessment team surveyed the area and provided recommendations on where possible signage could be placed, however, input from the community will be needed to decide if those spots will be the best location. This would be a great way to bring in other groups who have expressed interest in providing input like the equestrian club, a small group of quad bikers, and the cross-country team.

Additionally, Ms. Flynn, the kindergarten teacher who we worked with offered to connect us with other classrooms. She suggested doing an activity with an older age group at the elementary school. Connecting with middle and high school students will allow for a different perspective. Most students seemed very intrigued the few times we interacted with them, a lot of them use the parks and open spaces. Since they are a large part of the population we are planning for their opinions and knowledge should be integrated into our recommendations. The school is also a great way to get parents involved.

Populations that we did not get to reach out to include minority groups such as the growing Hispanic population, we feel it is important to involve them in this process, this can be done by translating information to a different language. The community alliance group was said to be a group that has been doing work connecting with the Hispanic population in town. This group could be key to start developing a relationship in order to ensure we are bringing in a diverse range of perspectives to the work we do in the city of Sultan.

Overall, we found that the city of Sultan was eager to be a part of this process. The connections we were able to start have great potential for future work. Going forward, providing opportunities for residents to engage with the work we do will establish a collaborative partnership. This is imperative to the work we do because want to provide Sultan the opportunity to strengthen their community and effectively plan for their future and current residents.



REFERENCES

- "City of Sultan PROS Plan." City of Sultan PROS Plan. City of Sultan, December 16, 2010. <https://www.ci.sultan.wa.us/DocumentCenter/View/178/Parks-Recreation-and-Open-Space-Plan-PDF>.
- Dannenberg, Andrew L., Todd W. Cramer, and Christopher J. Gibson. "Assessing the Walkability of the Workplace: A New Audit Tool." *American Journal of Health Promotion* 20, no. 1 (2005): 39–44. <https://doi.org/10.4278/0890-1171-20.1.39>.
- Gemzøe, Lars. Gehl Architects, October 2006.
- "2016 NRPA Field Report." National Recreation and Parks Association, 2016. https://www.nrpa.org/uploadedFiles/nrpa.org/Publications_and_Research/Research/Field-Report.pdf.
- Moeller, John. "Standards for Outdoor Recreational Areas." *Standards for Outdoor Recreational Areas*. American Planning Association, January 1965. <https://www.planning.org/pas/reports/report194.htm>.
- USDA. 2007. "Trail Construction and Maintenance Notebook."
- Sultan Community Alliance. "Trunk or Treat Main Street." Accessed December 8, 2019. <https://www.facebook.com/events/main-st-sultan-wa-98294-united-states/trunk-or-treat-main-street/1097277837113314/>.

APPENDICES

APPENDIX 1: DEMOGRAPHIC PROFILE

<div> </div>					
DEMOGRAPHIC PROFILE CITY OF SULTAN					
	2017	% CHANGE	2010	% CHANGE	2000
Residents	5,194	11.67%	4,651	39.5%	3,334
Median Age	35.6	10.22%	32.3	0.0%	32.3
Families	1,229	7.62%	1,142	33.1%	858
Households	1,911	18.92%	1,607	24.5%	1,291
Average household size	2.59	-10.38%	2.89	4.7%	2.76
Median household income	\$66,250	42.11%	\$46,619	-0.6%	\$46,921
Per capita income	\$30,343	26.60%	\$23,968	27.3%	\$18,822
Percent below poverty line	8.40%	-39.13%	13.80%	97.1%	7%
Unemployment rate	10.40%	31.65%	7.90%	64.6%	4.80%
POPULATION					
White alone	76.00%	-11.83%	86.20%	-5.9%	91.60%
Percent of population non-white	24%	73.91%	13.80%	64.3%	8.40%
Black or African American	0%	-100.00%	0.20%	-33.3%	0.30%
Asian	2.40%	50.00%	1.60%	0.0%	1.60%
American Indian/Alaska Native	1.40%	40.00%	1%	-16.7%	1.20%
Hispanic/Latino	10.90%	-10.66%	12.20%	154.2%	4.80%
Native Hawaiian/Pacific Islander	0.90%	350.00%	0.20%	100.0%	0.10%
Other race	0.05%	-99.30%	7.10%	343.8%	1.60%
Multiracial	2.40%	-35.14%	3.70%	-7.5%	4.00%
Median home value	\$233,100	-4.90%	\$245,100	52.4%	\$160,800
Owner-Occupied Homes	1,345	18.50%	1,135	30.3%	871
Renter-Occupied Homes	566	19.92%	472	38.8%	340
HOUSING					
One-unit detached	1,572	4.94%	1,498	69.1%	886
One-unit attached + 2-4 units	229	30.86%	175	73.3%	101
Five or more units	104	35.06%	77	-10.5%	86
Mobile home, boat, RV, van, etc.	185	14.91%	161	-32.1%	237
COMMUTING					
Average commute time (minutes)	38.8	53.97%	25.2	-30.2%	36.1
Drove alone	77.60%	2.11%	76%	6.6%	71.30%
Rode transit	1.10%	-77.55%	4.90%	88.5%	2.60%
Carpooled	14.30%	37.50%	10.40%	-48.5%	20.20%
Walked	1.30%	-53.57%	2.80%	0.0%	2.80%
Worked at home	2.30%	-43.90%	4.10%	36.7%	3%

Sources: 2000 Census, 2010 Census, 2017 American Community Survey

APPENDIX 2: TRAILS ASSESSMENTS

	Protection against weather and traffic	ADA accessibility potential	Resting	Visibility	Scale	Positive aspects of climate	Aesthetic quality	Litter and trash	Signage
Evac/High St. Trail	good; away from the road, trees provide cover	needs some work; wide, but pretty steep	needs some work	good	good; wide enough for a vehicle	good; sunny but provides for shade	needs some work	good	needs significant work
Susie's Trail and North Loop	good; winds through big trees, away from the road	good; wide, no bumps or holes	good; 3 benches along north trail; a few bridges	needs some work; no lighting but good sightlines	good; saw 2 bikes, 1 other person	good; nice breeze from the river	good	needs some work; some trash near Susie's Trail trailhead	needs significant work; signs at beginning, end, none along the way
Middle and South Loops	good; winds through big trees, away from the road	needs significant work; pretty narrow and bumpy in some areas	needs some work; a couple bridges but no benches	needs some work; no lighting, can be hard to see around corners	needs some work; might be too narrow for bikes in some areas	good; nice breeze from the river	good	good	needs significant work; signs at beginning, end, none along the way

Scale: Good -- Needs Some Work -- Needs Significant Work

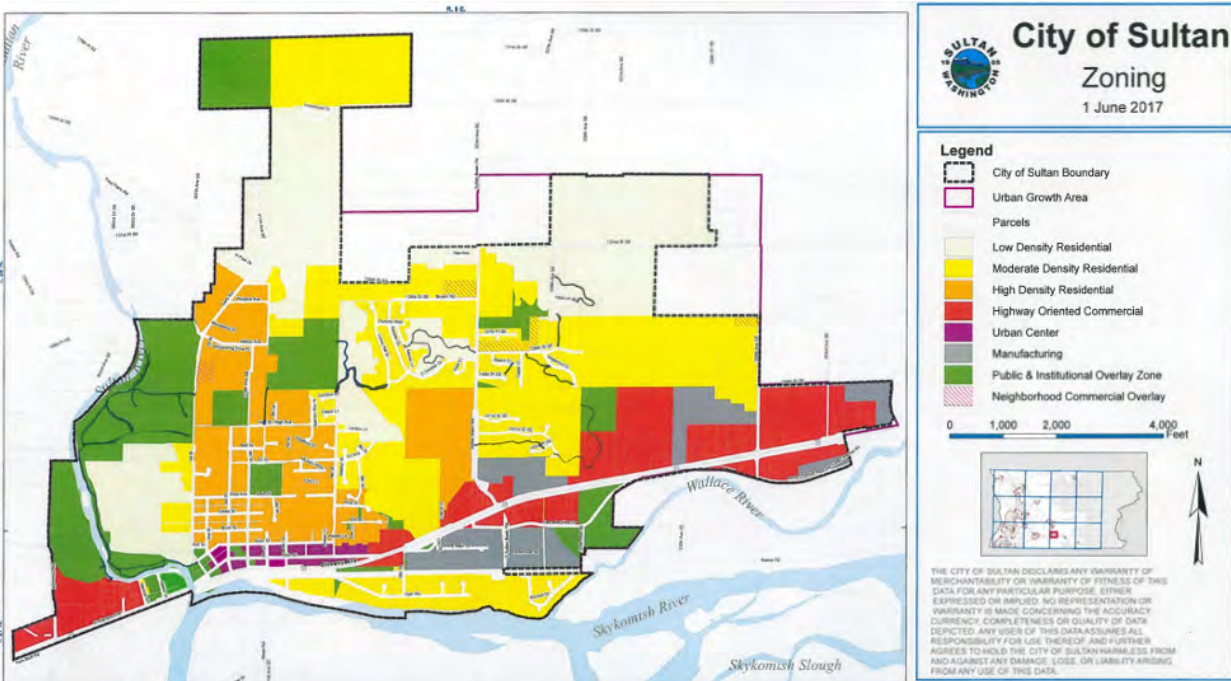

Map of Sultan's trails provided by Andy Galuska, Planning Director

APPENDIX 3: PARKS ASSESSMENTS

Park: *Reece* **Date:** *11.8.19* **Assessor's Name:** *Jenna Brewington*

(Rating Questions)

Safety from automobiles/traffic

(needs significant work).....(needs some work).....(*good*)

Personal Safety (sightlines, lighting, etc.)

(needs significant work).....(*needs some work*).....(*good*)

Pedestrian Access

(*needs significant work*).....(needs some work).....(*good*)

Activities

(needs significant work).....(needs some work).....(*good*)

Universal Accessibility

(*needs significant work*).....(needs some work).....(*good*)

Maintenance

(needs significant work).....(needs some work).....(*good*)

Access to Nature

(needs significant work).....(needs some work).....(*good*)

(Observation Questions)

Describe the surrounding area.

- Older lady with two dogs unleashed by baseball fields
- Lights
- Two baseball backstops -- one with field/drift (poor overgrowth, still visibly but dirty)
- Further soccer goal and backstop -- secluded field, overgrown grass
- Some loud noises heard in the distance, and someone seemingly sleeping in a white van

What are the possible activities? (Sitting, walking, play/unfolding activities, etc.)

Play structure, grills, sports (baseball primarily), field games, dog walk, walk loops around, sit under cover

Does this park feel safe? If so, why? If not, why not?

Yes -- poor but also some light, not good visibility. Seclusion adds to safe feel (but bad vibes). Cleared out good paths.

Park: *Reece* **Date:** *11.8.19* **Assessor's Name:** *Kate Merifield*

(Rating Questions)

Safety from automobiles/traffic

(needs significant work).....(needs some work).....(*good*)

Personal Safety (sightlines, lighting, etc.)

(needs significant work).....(*needs some work*).....(*good*)



INITIAL PARKS AND TRAILS ASSESSMENT

Pedestrian Access

(needs significant work).....(needs some work).....(good)

Activities

(needs significant work).....(needs some work).....(good)

Universal Accessibility

(needs significant work).....(needs some work).....(good)

Maintenance

(needs significant work).....(needs some work).....(good)

Access to Nature

(needs significant work).....(needs some work).....(good)

Notes:

Bad sight lines - feels very secluded

(Observation Questions)

Describe the surrounding area.

Off of a back road with little pedestrian access to the park from the road

Some homes in view

Forests on other sides

What are the possible activities? (Sitting, walking, play/unfolding activities, ect.)

Playing, sitting, walking, baseball, soccer, cooking

Does this park feel safe? If so, why? If not, why not?

Somewhat/not really -- bad sight lines, many hidden spaces

Park: Osprey

Date: 11.8.19

Assessor's Name: Jenna Brewington

(Rating Questions)

Safety from automobiles/traffic

(needs significant work).....(needs some work).....(good)

Comment: near "busy" road but feels safe/good

Personal Safety (sightlines, lighting, etc.)

(needs significant work).....(needs some work).....(good)

Comment: some secluded/worrisome corners but overall great visibility

Pedestrian Access

(needs significant work).....(needs some work).....(good)

Activities

(needs significant work).....(needs some work).....(good)

Comment: soccer/organized sport, play structures, people sitting and talking

Universal Accessibility

(needs significant work).....(needs some work).....(good)

Comment: feels to be "central Sultan"

Maintenance

(needs significant work).....(needs some work).....(good)

Comment: main problems - litter by basketball cover, few soccer posts rusted

Access to Nature

(needs significant work).....(needs some work).....(good)

(Observation Questions)

Describe the surrounding area.

- Soccer goals - some painted gold which makes them appear rusty/in disrepair from far away
- Right next to residential area/homes = people connect, frequent park directly from homes + after school
- Old zipline in front of park?
- Conversation with Katie (12-years-old, lives in a house facing park) who came up to me asked what I'm doing:
 - Bathrooms not very clean - very smelly
 - Bike around park (green machine bike)
 - Dogs get in fights at dog park if they don't get along/like each other. Dog park new.
 - [Non-Osprey, sultan highlights to her]:
 - Rope swing by Osprey trail by soccer field opening
 - River close to Hwy 2 - rope swing kids play on, by bridges just further downstream (skyvalley river), farmer guy has a box and requests money if people travel past it on the river edge, by the Hoko pit
 - Big Rock
 - Big Eddie lagune

What are the possible activities? (Sitting, walking, play/unfolding activities, ect.)

- Benches: sit and observe
- Picnic
- Organized sport (primarily soccer and pickup basketball)
- Walk (perimeter is a good lap/route)
- Play structure (several kids playing and their parents were around)
- Potential: field games

Does this park feel safe? If so, why? If not, why not?

Yes! If anything, edges by entrances to trails might feel a little mysterious.

Park: Osprey

Date: 11.8.19

Assessor's Name: Kate

Merifield

(Rating Questions)

Safety from automobiles/traffic

(needs significant work).....(needs some work).....(good)

Personal Safety (sightlines, lighting, etc.)



(needs significant work).....(needs some work).....().....(good)

Pedestrian Access

(needs significant work).....(needs some work).....(good)

Activities

(needs significant work).....(needs some work).....(good)

Universal Accessibility

(needs significant work).....(needs some work).....(good)

Maintenance

(needs significant work).....(needs some work).....(good)

Access to Nature

(needs significant work).....(needs some work).....(good)

(Observation Questions)

Describe the surrounding area.

Open fields and houses nearby, a somewhat busy road, some kind of industrial site nearby

What are the possible activities? (Sitting, walking, play/unfolding activities, ect.)

Playing, sitting, walking, basketball, soccer, baseball

Does this park feel safe? If so, why? If not, why not?

Yes, there is enough of a border from the road, the grounds are well kept, and it is fairly open with good sightlines

Park: Skate

Date: 11.8.19

Assessor's Name: Jenna Brewington

(Rating Questions)

Safety from automobiles/traffic

(needs significant work).....(needs some work).....(good)

Personal Safety (sightlines, lighting, etc.)

(needs significant work).....(needs some work).....(good)

Notes: no lights but very central and open

Pedestrian Access

(needs significant work).....(needs some work).....(good)

Activities

(needs significant work).....(needs some work).....(good)

Universal Accessibility

(needs significant work).....(needs some work).....(good)

Notes: paths within grass or is more beneficial to have open, unobstructed field?

**Maintenance**

(needs significant work).....(needs some work).....(good)

*Notes: green grass, clean, no litter***Access to Nature**

(needs significant work).....(needs some work).....(good)

*Notes: promote susie's trail ?***Notes:**

- 2 porta potties by fence entrance to Skate area → assuming for construction?

(Observation Questions)

Describe the surrounding area.

By a residential area, a major highway, the city center, and then entrance to a major/main nature trail

What are the possible activities? (Sitting, walking, play/unfolding activities, ect.)

Skate, walk border, various field games

Does this park feel safe? If so, why? If not, why not?

Yes, good lighting and visibility

Park: Skate**Date: 11.8.19****Assessor's Name: Kate Merifield****(Rating Questions)**

Safety from automobiles/traffic

(needs significant work).....(needs some work).....(good)

Personal Safety (sightlines, lighting, etc.)

(needs significant work).....(needs some work).....(good)

Pedestrian Access

(needs significant work).....(needs some work).....(good)

Activities

(needs significant work).....(needs some work).....(good)

Universal Accessibility

(needs significant work).....(needs some work).....(good)

Maintenance

(needs significant work).....(needs some work).....(good)

Access to Nature

(needs significant work).....(needs some work).....(good)

Notes:

Honey Buckets in the park but seem as if they may be there for the construction next to the park

(Observation Questions)

Describe the surrounding area.

There are buildings (homes and non-retail businesses) nearby. Also near the river. A fence surrounds the skate park and there is a well tended lawn around the fence.

What are the possible activities? (Sitting, walking, play/unfolding activities, ect.)

Skateboarding, rollerblading

*Note -- honey buckets as bathrooms and no easy to find trash cans, also no lights

Does this park feel safe? If so, why? If not, why not?

Yes, but there are no street lights and outside of the fenced area it seemed exposed to vehicle traffic (although there is not much traffic in the area)

Park: Sportsmans

Date: 11.25.19

Assessor's Name: Jenna Brewington

(Rating Questions)

Safety from automobiles/traffic

(needs significant work).....(needs some work).....(good)

Personal Safety (sightlines, lighting, etc.)

(needs significant work).....(needs some work).....(good)

Notes: Doesn't have lights - but good overall visibility within park

Pedestrian Access

(needs significant work).....(needs some work).....(good)

Notes: building pedestrian bridge → soon to be good

Activities

(needs significant work).....(needs some work).....(good)

Notes: Intended to be a "simple park" (without play structures, etc)

Universal Accessibility

(needs significant work).....(needs some work).....(good)

Notes: good road access/paths to park, but not paths within park

Maintenance

(needs significant work).....(needs some work).....(good)

Access to Nature

(needs significant work).....(needs some work).....(good)

Notes: Flip side to universal accessibility (lack of paths within park) = open, natural fields = more nature-esque.

Good view of river. Con: next to highway = not nature-esque

(Observation Questions)

Describe the surrounding area.

- Construction gives "weird", temporary perspective
- Lots of trees, many large
- Can see "center of Sultan"/homes through trees and across river
- White barriers

What are the possible activities? (Sitting, walking, play/unfolding activities, ect.)

Walk, picnic, nature/people walking

Does this park feel safe? If so, why? If not, why not?

Yes

- Eyes from highway
- Moderately small park space helps with visibility
- Shouting distance to parks across river
- When present, construction workers = extra eyes on the street

Park: Sportsmans

Date: 11.25.19

Assessor's Name: Kate Merifield

(Rating Questions)

Safety from automobiles/traffic

(needs significant work).....(needs some work).....(good)

Personal Safety (sightlines, lighting, etc.)

(needs significant work).....(needs some work).....(good)

Pedestrian Access

(needs significant work).....(needs some work).....(good)

Activities

(needs significant work).....(needs some work).....(good)

Universal Accessibility

(needs significant work).....(needs some work).....(good)

Maintenance

(needs significant work).....(needs some work).....(good)

Access to Nature

(needs significant work).....(needs some work).....(good)

Notes:

There was construction while we were there -- we tried to assess the side without construction

(Observation Questions)

Describe the surrounding area.

Right next to a major road and the river, forested on one side, and also next to the water treatment plant

What are the possible activities? (Sitting, walking, play/unfolding activities, ect.)

Sitting, walking, eating/grilling, nature appreciation

Does this park feel safe? If so, why? If not, why not?

Yes, however there are no lights in the park. We were there during the day so it was fine but at night I would feel uncomfortable

**Park: Riverside****Date: 11.25.19****Assessor's Name: Jenna Brewington****(Rating Questions)**

Safety from automobiles/traffic

(needs significant work).....(needs some work).....(good)

Notes: cars on road consistently, BUT moving slow enough and visibility around corner is good

Personal Safety (sightlines, lighting, etc.)

(needs significant work).....(needs some work).....(good)

Pedestrian Access

(needs significant work).....(needs some work).....(good)

Notes: Close to the center of town

Activities

(needs significant work).....(needs some work).....(good)

Universal Accessibility

(needs significant work).....(needs some work).....(good)

Maintenance

(needs significant work).....(needs some work).....(good)

Access to Nature

(needs significant work).....(needs some work).....(good)

*Notes: Near Susie's Trail. Con: (unavoidable) close to highway***(Observation Questions)**

Describe the surrounding area.

- Bridge to Susie's Trail ← very good quality
- Balance between traffic and pedestrians freely crossing
- Feel of parks (Skate and Riverside) merged as one

What are the possible activities? (Sitting, walking, play/unfolding activities, ect.)

Walk, people/nature view, rest, picnic, sit, visit memorial

Does this park feel safe? If so, why? If not, why not?

Yes, very close to town activity, busy road, etc.

Park: Riverside**Date: 11.25.19****Assessor's Name: Kate Merifield****(Rating Questions)**

Safety from automobiles/traffic

(needs significant work).....(needs some work).....(good)

Personal Safety (sightlines, lighting, etc.)

(needs significant work).....(needs some work).....(good)

Pedestrian Access

(needs significant work).....(needs some work).....(good)

Activities

(needs significant work).....(needs some work).....(good)

Universal Accessibility

(needs significant work).....(needs some work).....(good)

Maintenance

(needs significant work).....(needs some work).....(good)

Access to Nature

(needs significant work).....(needs some work).....(good)

(Observation Questions)

Describe the surrounding area.

(Same as skate park)

Close to bridge and main road

Close to some residential streets

Next to eh skate park

Access to the river and Suzies trail

What are the possible activities? (Sitting, walking, play/unfolding activities, ect.)

Sitting, walking, looking at nature

Does this park feel safe? If so, why? If not, why not?

Yes, near town and road activity nearby

Park: Cemetery/Ballfields **Date:** 11.25.19 **Assessor's Name:** Jenna Brewington

(Rating Questions)

Safety from automobiles/traffic

(needs significant work).....(needs some work).....(good)

Personal Safety (sightlines, lighting, etc.)

(needs significant work).....(needs some work).....(good)

Notes: sightlines within are OK; very removed park from activity; strange car in cemetery while we were there

Pedestrian Access

(needs significant work).....(needs some work).....(good)

Notes: not easy to get here by foot; paths within ark are good (plus their layout/location), BUT one leading to the baseball field is in bad shape

Activities

(needs significant work).....(needs some work).....(good)

Notes: only main activity is baseball, would feel weird/intrusive to walk around or picnic because of occupied houses on one end and cemetery on other

Universal Accessibility

(needs significant work).....(needs some work).....(good)

Maintenance

(needs significant work).....(needs some work).....(good)

Notes: Could play ball if wanted (functional) but fence/backstop and field need attention to become "good" and expected level of maintenance

Access to Nature

(needs significant work).....(needs some work).....(good)

Notes: Feels as if you're within valley, surrounded by trees, but also cars quickly visible.

(Observation Questions)

Describe the surrounding area.

- No sights (that we saw) on Hwy 2 identifying park
- Boundaries of the park itself are very unclear
- Overall forgotten feel

What are the possible activities? (Sitting, walking, play/unfolding activities, ect.)

Baseball, walk, picnic?

Does this park feel safe? If so, why? If not, why not?

Medium (yes/no).

- Secluded and moderately run-down but next to "nice" houses and not bad technically, just generally didn't feel good there

Park: **Cemetery/Ballfields**

Date: **11.25.19**

Assessor's Name: **Kate Merifield**

(Rating Questions)

Safety from automobiles/traffic

(needs significant work).....(needs some work).....(good)

Personal Safety (sightlines, lighting, etc.)

(needs significant work).....(needs some work).....(good)

Pedestrian Access

(needs significant work).....(needs some work).....(good)

Activities

(needs significant work).....(needs some work).....(good)

Universal Accessibility

(needs significant work).....(needs some work).....(good)

Maintenance

(needs significant work).....(needs some work).....(good)



INITIAL PARKS AND TRAILS ASSESSMENT

Access to Nature

(needs significant work).....(needs some work).....(good)

Notes:

Hard to tell where park starts and ends -- there are very little signs

(Observation Questions)

Describe the surrounding area.

Private residential areas surrounding park and bordered on one side by a fence

What are the possible activities? (Sitting, walking, play/unfolding activities, ect.)

Baseball, play in open field, walking through cemetery

Does this park feel safe? If so, why? If not, why not?

Yes, but no lights, sight lines across the park are good but not beyond the park, and very few car/people nearby

Park: Travelers

Date: 11.25.19

Assessor's Name: Jenna Brewington

(Rating Questions)

Safety from automobiles/traffic

(needs significant work).....(needs some work).....(good)

Cavet: close to rail road is dangerous but kind of unavoidable

Notes: Stakes with red dots to enter and help see driveway helped but could have something more visible (I almost missed the entrance when visiting because couldn't see where started)

Personal Safety (sightlines, lighting, etc.)

(needs significant work).....(needs some work).....(good)

Pedestrian Access

(needs significant work).....(needs some work).....(good)

Cavet: No pedestrian access to get to the park from the city. BUT good walkability within

Activities

(needs significant work).....(needs some work).....(good)

Universal Accessibility

(needs significant work).....(needs some work).....(good)

Maintenance

(needs significant work).....(needs some work).....(good)

Notes: Very good, cleaned, maintained park (one of the best in Sultan)

Access to Nature

(needs significant work).....(needs some work).....(good)

Notes: Not necessarily intended to have great access to nature, but even so has good amount of trees, etc which gives it a good nature feel.

(Observation Questions)

Describe the surrounding area.

Artsy stick structure, open and good sightlines of park, slight incline in the last ~2 feet to road and railway

What are the possible activities? (Sitting, walking, play/unfolding activities, ect.)

Walk, picnic, view historic things (tree round..)

Does this park feel safe? If so, why? If not, why not?

Yes regarding violence/shady activity

Slightly regarding personal safety -- close to road and railroad but a decent hill/bump/incline leading up to both

Park: Travelers

Date: 11.25.19

Assessor's Name: Kate Merifield

(Rating Questions)

Safety from automobiles/traffic

(needs significant work).....(needs some work).....(good)

Personal Safety (sightlines, lighting, etc.)

(needs significant work).....(needs some work).....(good)

Pedestrian Access

(needs significant work).....(needs some work).....(good)

Activities

(needs significant work).....(needs some work).....(good)

Universal Accessibility

(needs significant work).....(needs some work).....(good)

Maintenance

(needs significant work).....(needs some work).....(good)

Access to Nature

(needs significant work).....(needs some work).....(good)

(Observation Questions)

Describe the surrounding area.

Between a main road and a railroad track, at one end (West?) it is near commercial activity

What are the possible activities? (Sitting, walking, play/unfolding activities, ect.)

Walking, sitting, eating, looking at large covered art piece/sign

Does this park feel safe? If so, why? If not, why not?

Yes, except proximity to railroad tracks, near activity but no lights



APPENDIX 4: NOTABLE SURVEY RESPONSES

It's sad that Sultan has such poor parks. I had to pay city of Monroe to rent a gazebo at one of their parks for my son's birthday. Would have loved to have kept it local. But bums and needles plague Sultan.
To use the skate park supplies that have been sitting collecting dust for years. Add more trails and more river access
More community awareness as to what is already available.
If it hadn't been for the Salmon Festival I would have never know[n] of the vastness of Osprey Park. Within the picnic and play area there is little signage and information to inform people of the hiking trails.
More safe access to water either to the river or to the ponds It would be nice to see Park and Recreation activities for our youth during Summer or weekends.
It would be nice to see Park and Recreation activities for our youth during Summer or weekends.
I would love to have more trails accessible from Sultan Basin! There's so much land up there, I'd love something out there, or even on the other side of Highway 2 by the hills. More hiking, please!
The city owned property by the old airport would be a great location for a park. The existing city trail by 138th would connect several communities to it within walking distance. This would be especially great on Sundays when we're trapped at home b/c of weekend traffic on hwy 2 and the basin.